

**Lom krila je 32mm na vsako stran**

Smerni rep - mehka balsa 2mm  
(1kos)

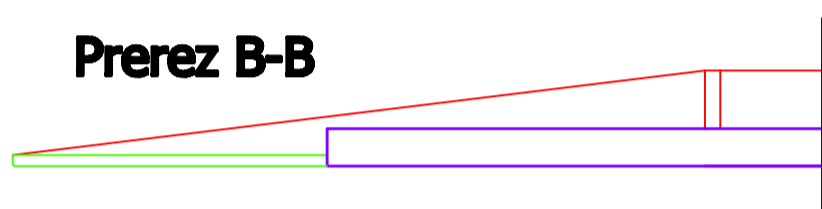

## Prerez A-A



## Prerez B-B



## Prerez C-C

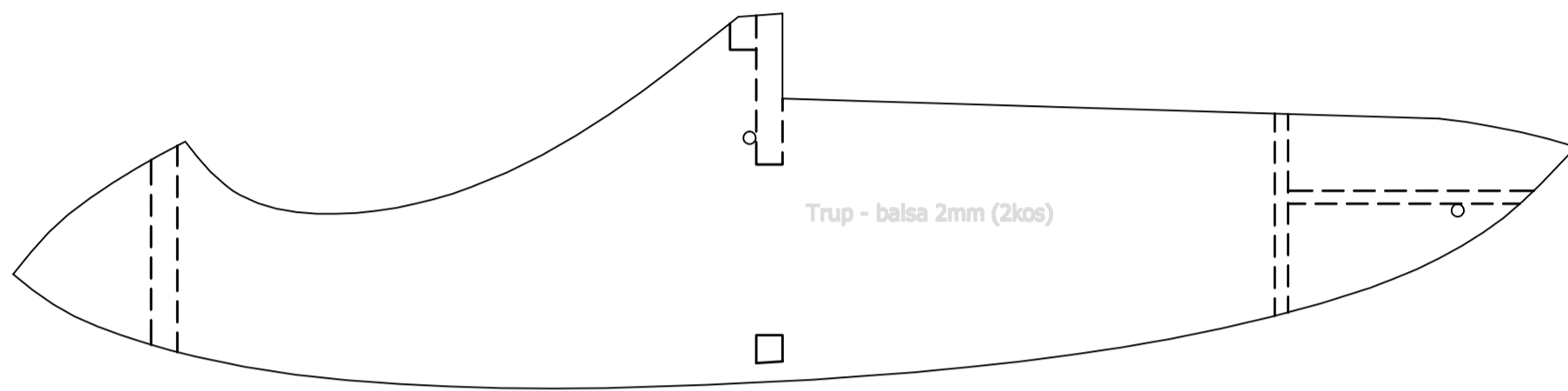

Višinski rep - mehka balsa 2mm  
(1kos)

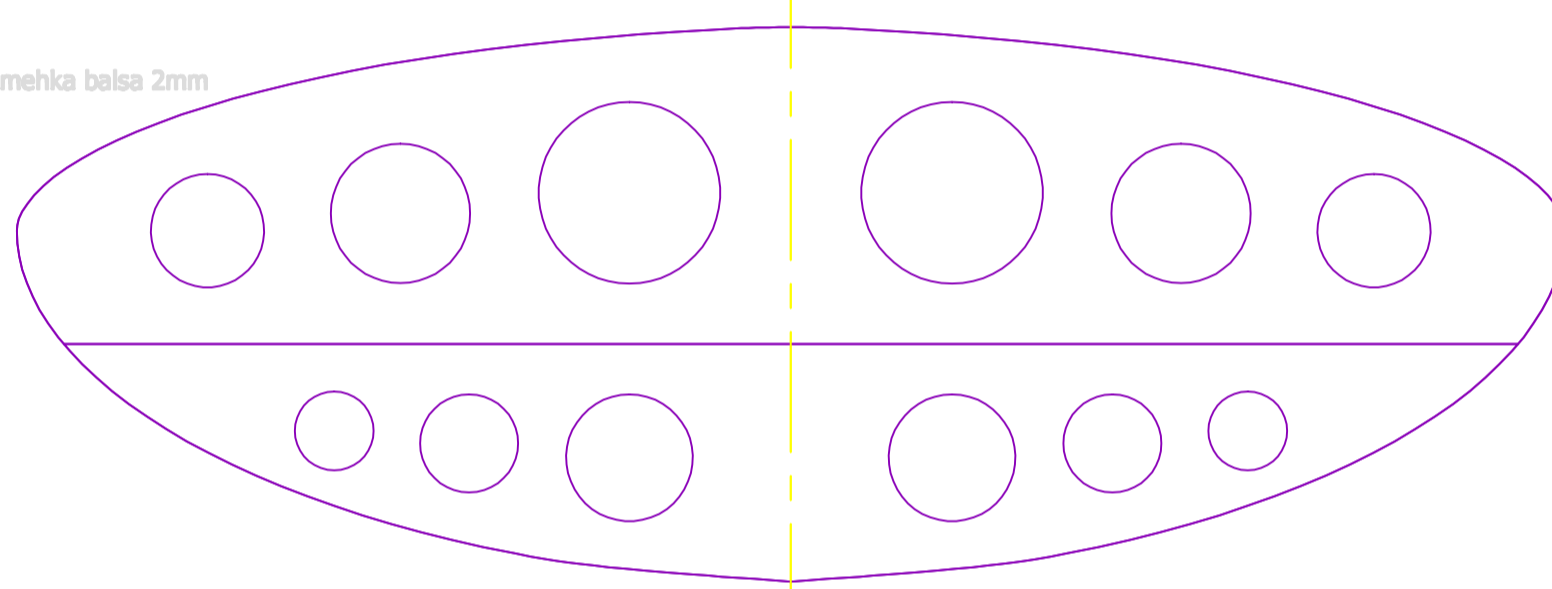

## Prerez D-D

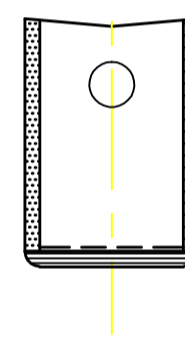

rebro 1 - balsa 2mm (4kos)



rebro 2 - balsa 2mm (10kos)

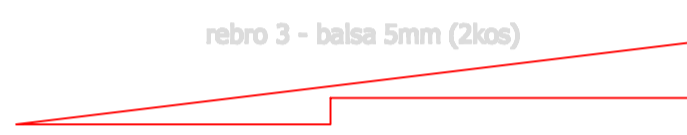

Letalska vezana plošča 1mm (2kor)

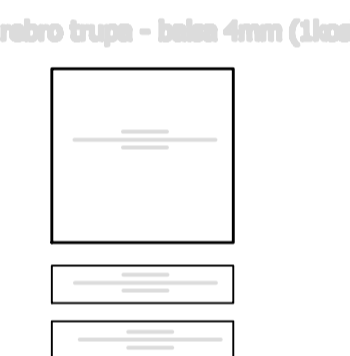

rebro trupa - beisa 4mm (1loc)

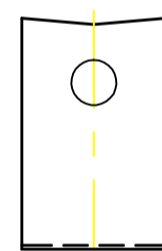
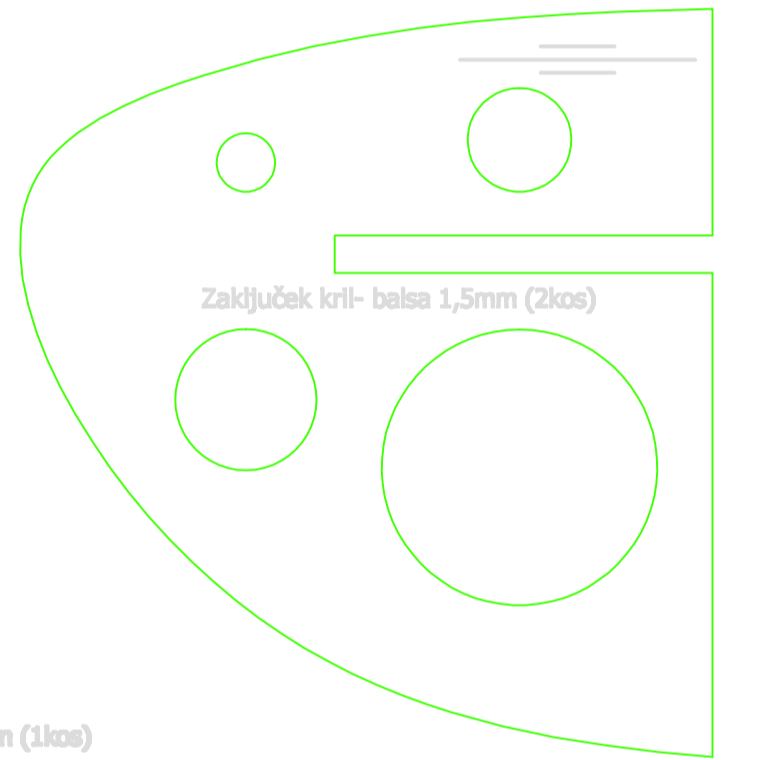

Rokice - vitroplas ali  
1mm letalska vezana  
plošča

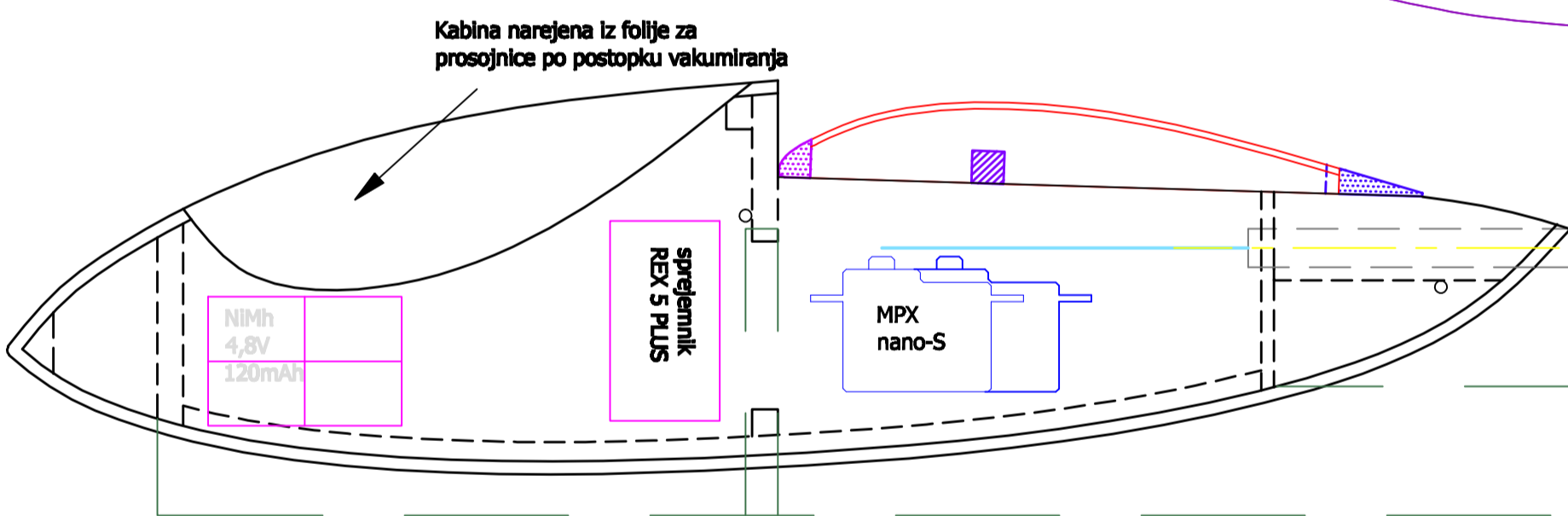
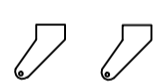

**Kabina narejena iz folije za  
prosojnice po postopku vakumiranja**

**sprejemnik  
REX 5 PLUS**

MPX  
nano-S

## Šablona za pritrditev palice na trup

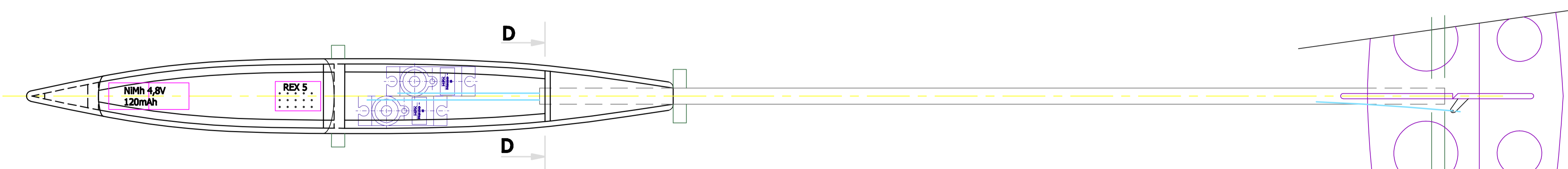

D

D

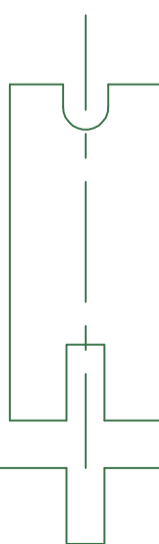
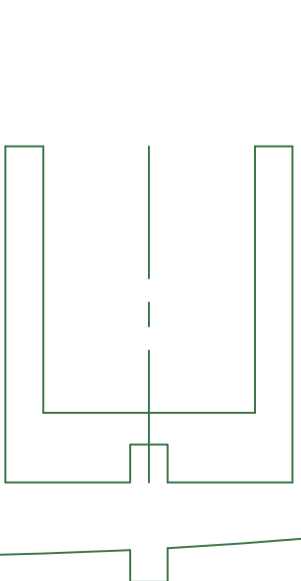
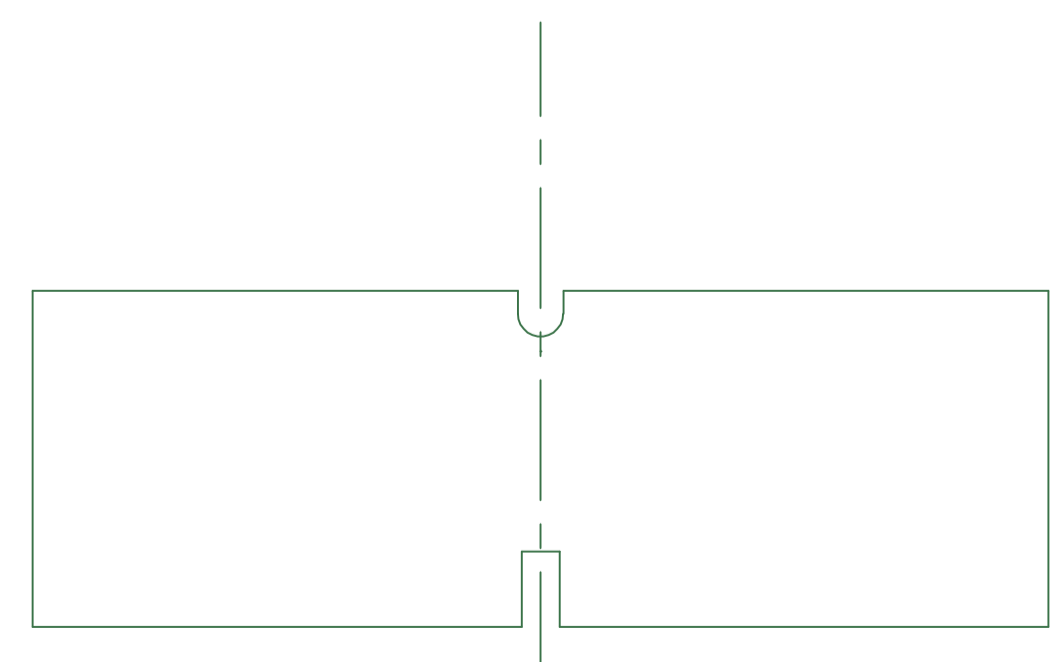
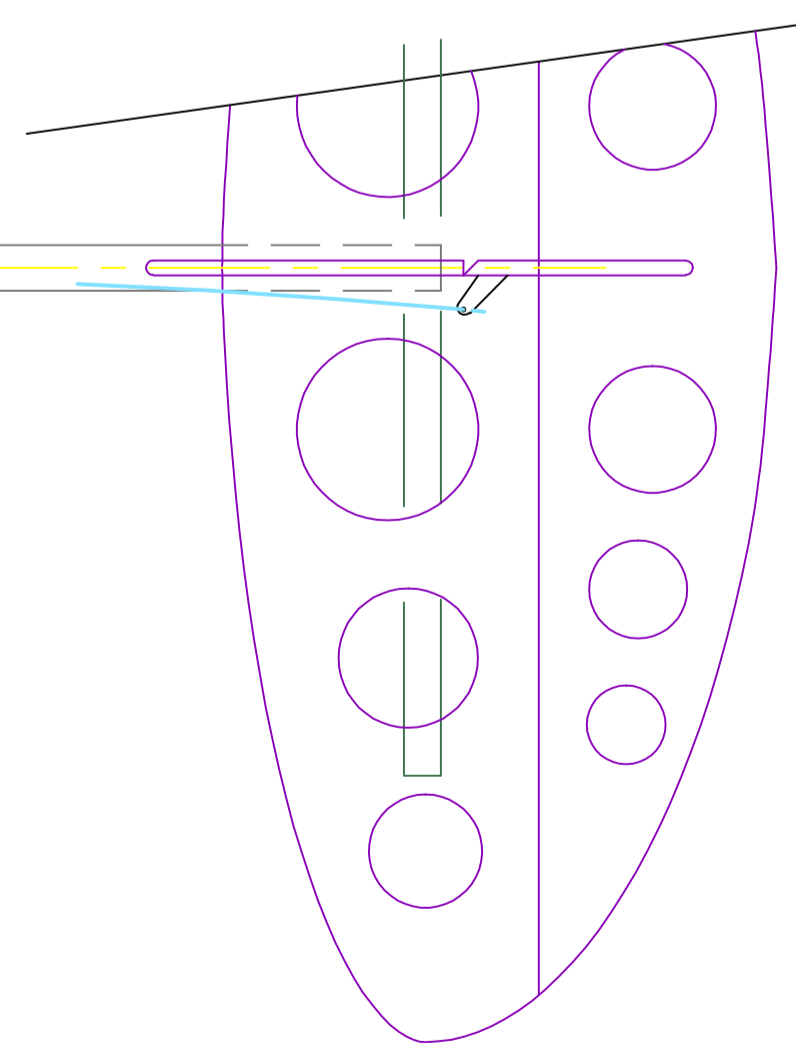

## Šablona za pritrditev palice na trup

